

120 Watt (PAS0201)

POLY CRYSTALLINE MODULE 72x(156mmx78mm)

Electrical Characteristics

| Model | Pm(Wp) | Tolerance | Vm(V) | Im(A) | Voc(V) | Isc(A) |
|---------|--------|-----------|-------|-------|--------|--------|
| SYP120S | 120W | +3% | 33.5 | 3.59 | 41.8 | 3.99 |

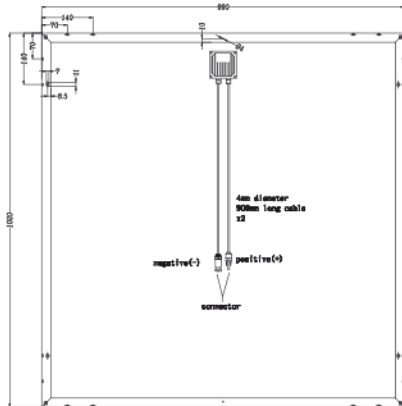
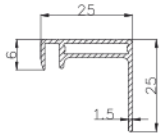

Valued at STC (AM 1.5, 1000W/m², 25°C)

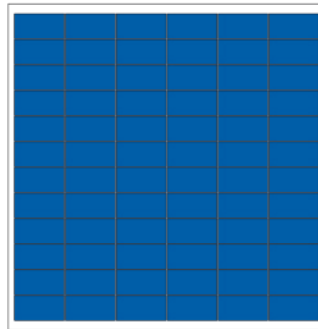

Specifications

- Number of poly crystalline solar cell 72pcsx(156mmX78mm)
- Aluminum frame, dimension 990x1020x25mm
- Weight 11.3kg
- Temperature coefficient of VOC(β)=-0.39%/°C
- Temperature coefficient of ISC(α)=+0.033%/°C
- Temperature coefficient of Pmax=-0.44%/°C
- Bypass diodes to reduce loss in partial shadow
- IP65
- CE Standard
- Performance test data for each module